

SMART LOCK INSTRUCTIONS

Attention to Smart Locks

- 1. The door lock device is equipped with a mechanical key to open the lock manually, remove the mechanical key from the packaging, and Keep them in a safe place (not in a room with a door lock) and can be found in other places Use it at any time in the case.
- 2. Open the battery cover plate. 4 sections 5 alkaline battery need to be installed. (No rechargeable battery can be used)
- 3. The door lock sets a standby time limit of 10 seconds when the door lock operates. If no operation is carried out during standby, The door lock will close in 10 seconds.
- 4. Keep your fingers clean when using the door lock device.

Language support

Languages: English, Portuguese, Spanish, Chinese.

! Before using this door lock device, please read this manual first and save it for future reference.

Overview of door lock panels

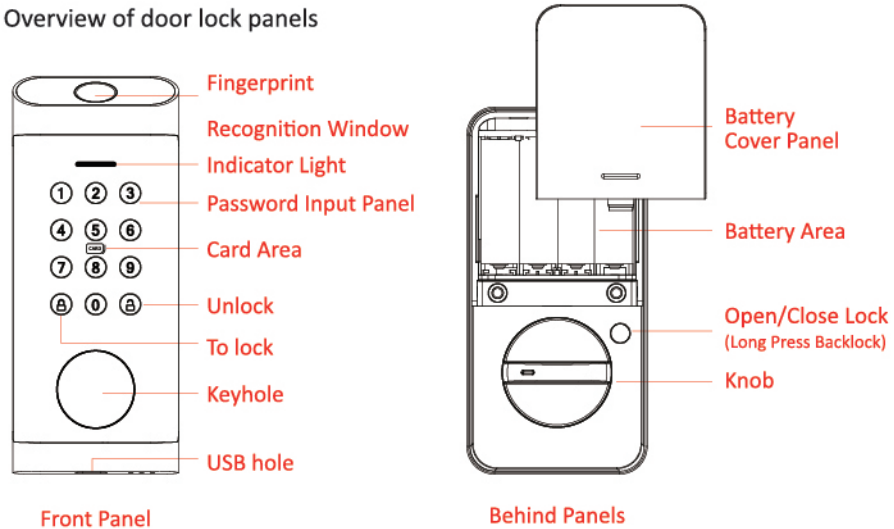

I. Product parameters

Door opening method	: APP / Fingerprint / Password / Swipe card / Key
Product colour	: Black , Nickel
System support	: Android 4.3/IOS7.0+
Bluetooth standard	: Bluetooth 4.1BLE
Panel material	: In-moulded touch screen
Material of the lock	: zinc alloy
Operating temperature	: -20°C~70°C
Working humidity	: 20%~80%RH
Standby current	: < 100 uA
Operating current	: < 250 mA
Motion mode	: Manual (optional door magnet to automatically lock)
Unlocking time	: ≈ 1.5S
Fingerprint type	: Semiconductor fingerprint head
Card type	: MIFARE M1 card
Password type	: Capacitive touch keys
Password capacity	: Custom passwords - 150 groups
Fingerprint capacity	: 100pcs
IC card capacity	: 200 cards
A pseudonymous password	: Yes
APP	: TUYA
Power supply	: 6V (4 x AA alkaline dry batteries)
Low voltage alarm	: ≤4.8V
Suitable for door thicknesses	: 35mm-50mm
Emergency charging port	: Typec interface

2. Inspection of basic accessories

Open the packaging and remove the products and accessories.

Check that the items are complete

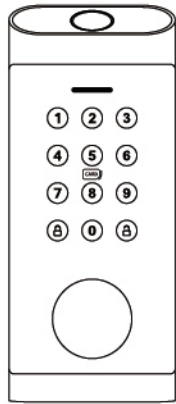

Front Panel

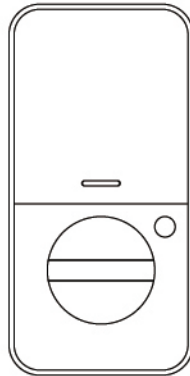

Behind Panels

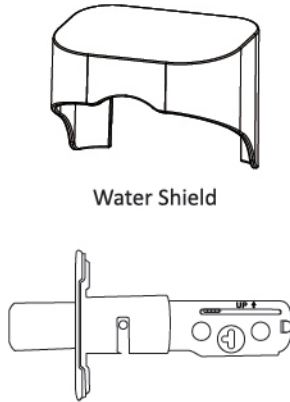

Water Shield

Monotonic Locks

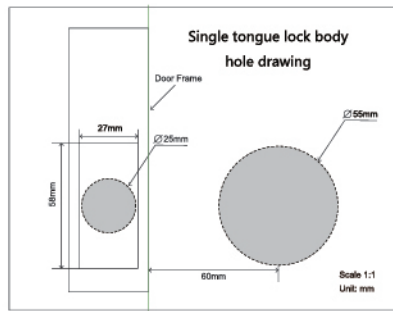

Orifice Diagram



Lock Pads



The Lock Box



Key



Card



40mm Flathead Screw



30mm Flathead Screw



20mm Flathead Screw

3. Product Dimensions

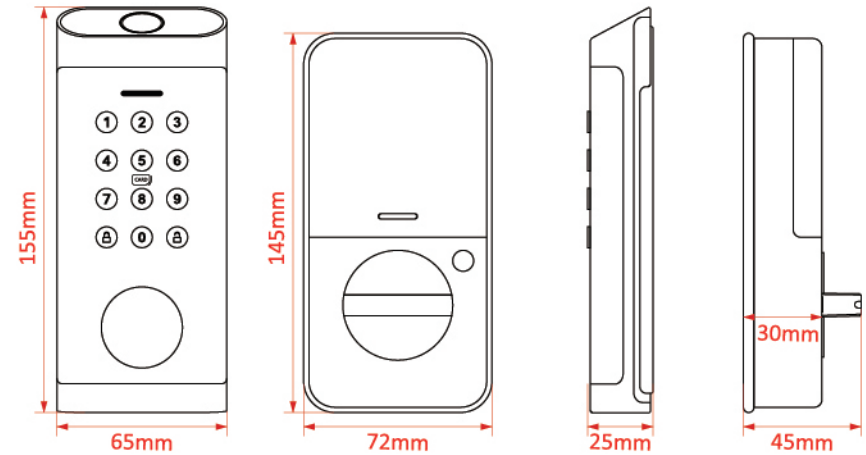

★ Manual measurements, there are errors, please use actual product dimensions.

4. Instructions for installation steps

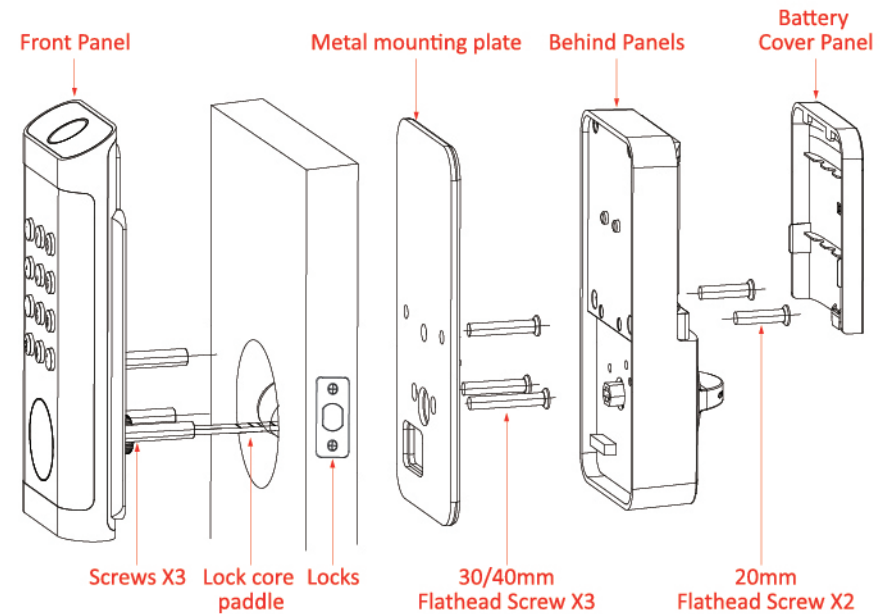

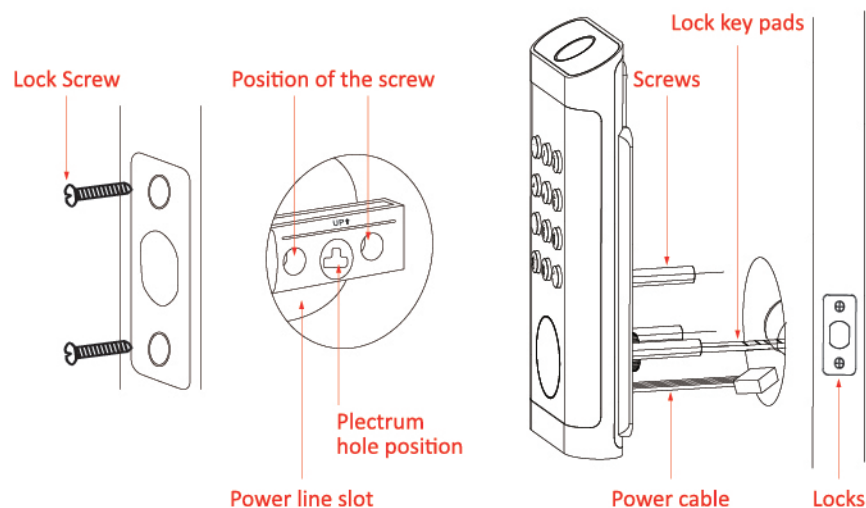

Install a lock

Place the lock in the corresponding slot and secure the lock with a screw.

Note: The orientation of the sliced hole is shown in the diagram

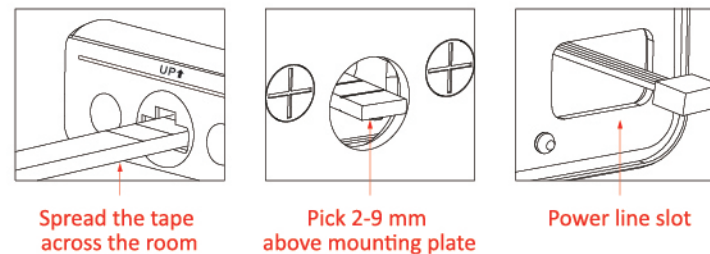
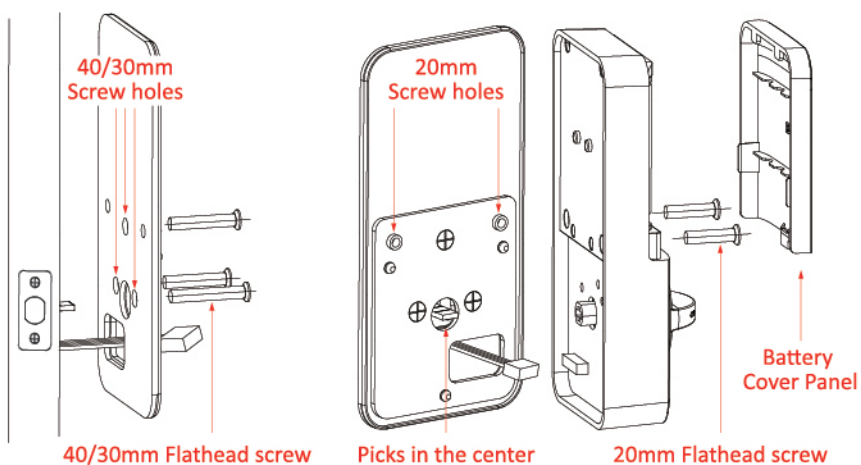

Install the front panel

The lock core diaphragm is placed horizontally through the diaphragmic hole on the lock and against the screw hole on the locks. The power line passes through the door frame and puts the front panel on the door. (Pick in the center of the hole, lock core pick length according to the actual door thickness with pointed nose pliers to cut the appropriate length, pick higher than the installation plate 2-9mm)

Metal mounting plate after fixing

Determine the position of the metal installation plate and pass the power line through the hole below the installation plate. Align the holes in the stud and the mounting plate and secure the mounting plate to the door with 40 / 30 mm flat head screws.

Install the back panel

Connect the power line to the rear panel port, open the battery cover, align the rear panel with the mounting plate, and secure it with 20mm flat head screws.

Install batteries

Install 4 sections 5 of the battery, test the power supply and unlock condition, and cover the battery cover.

Note:

The positive and negative electrodes of the battery are installed correctly, and the rotation knob should be smooth after completion.

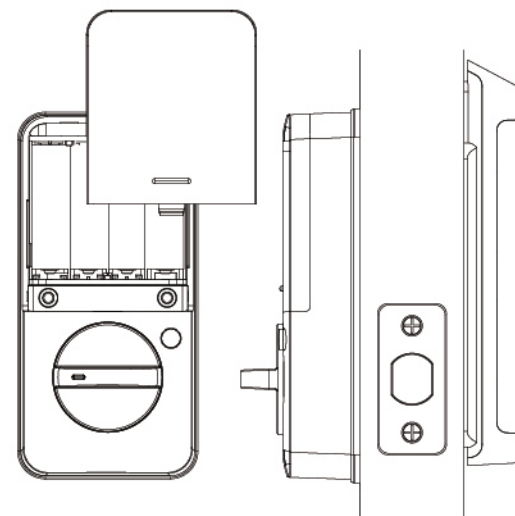

A. Network settings

Please search and download the “Tuya Smart” APP in the app store, or scan the QR code to download it, and remind registered users according to the software;

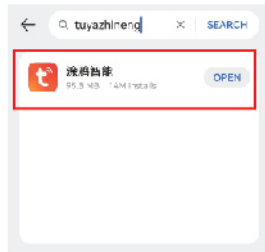

APP Registration, Login

Do not have an APP account, choose log in or log in via SMS verification code. Click Create New Account to enter the account registration page. According to the prompts to obtain SMS verification code, set password. If you already have an account, click "Log in with an existing account" to log in to the app. Login support password, verification code, social account login.

After the lock body enters the network configuration, open the “Tuya Smart” APP to pair the lock body, and enter the WiFi name and password used;

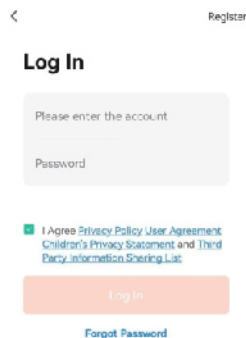
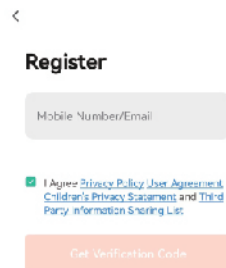

Add Device

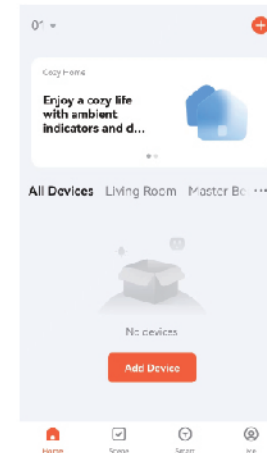

Click Add Device

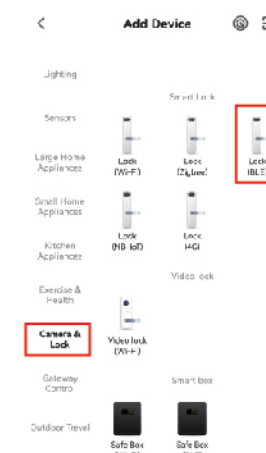

Find the Camera & Lock
Select Lock (BLE)



Select Start Bluetooth
Click Next

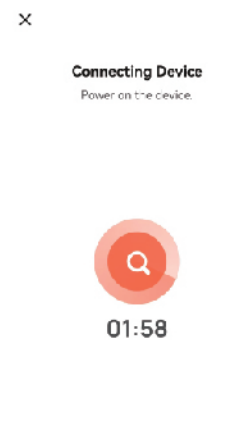

Touch Fingerprint
Wake Up System
Waiting Link Device

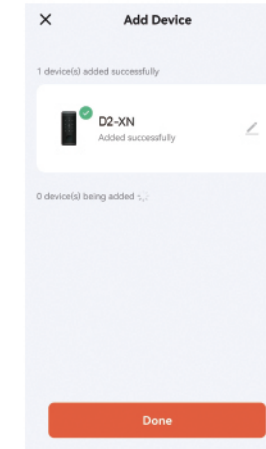

Link Success
Click to Done

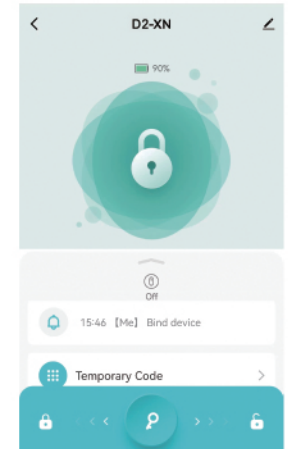

Enter the door lock
main interface

Member Management - Improving Family Members

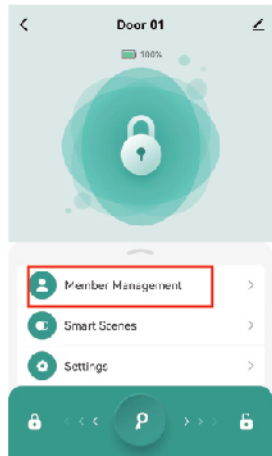

Click Member Management

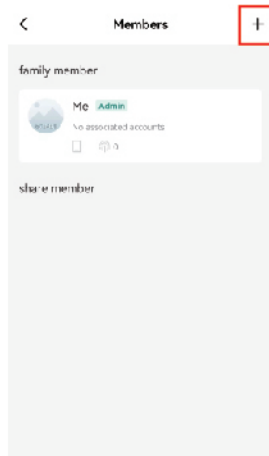

Click "+" on the top right

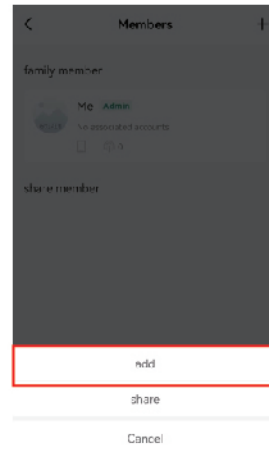

Select add

Member Management - Set Fingerprint Permissions

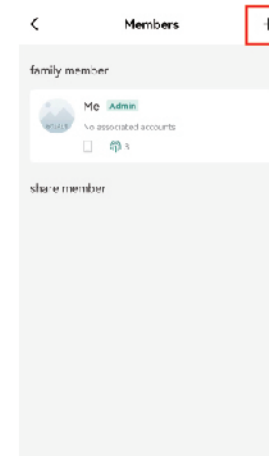

In the Member Admin Panel Click "+"

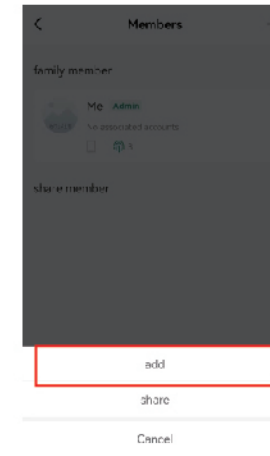

Click add

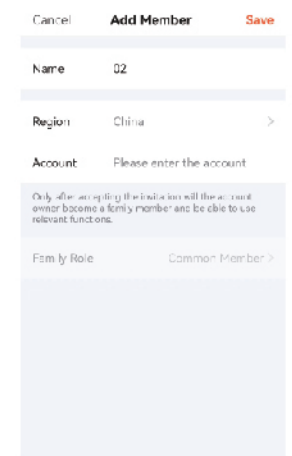

Set Member Name
Click to save

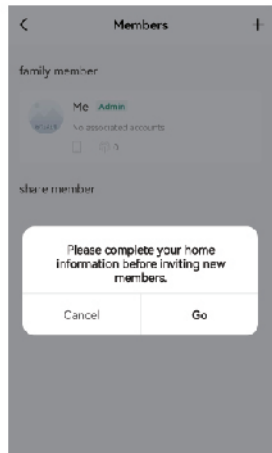

Click Go

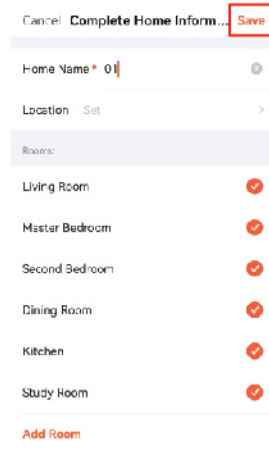

Improving Family Information Click Save

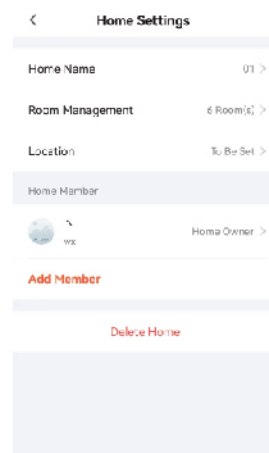

You can rename / view / add / remove when finished

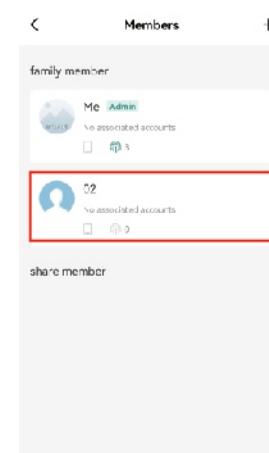

In the Member Admin Panel
Select the member

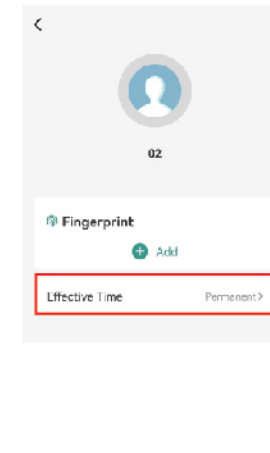

Select Effective Time

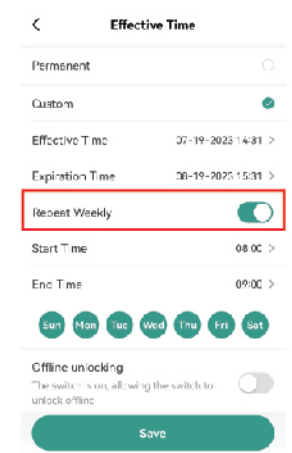

Select Custom, Set Fingerprint Permissions
Click Save

Setting the Administrator Fingerprint

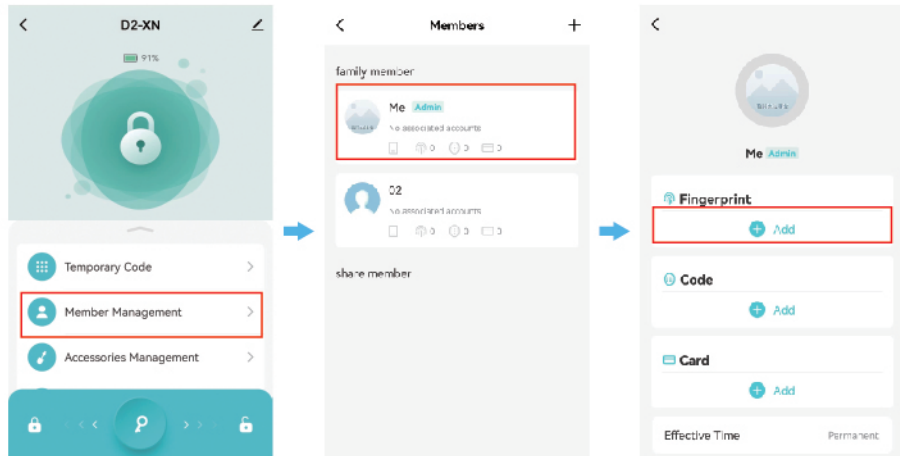

Select Member Management in Door Lock Interface

Select Me Admin

Click Add in the Fingerprint location of the Administrator Interface

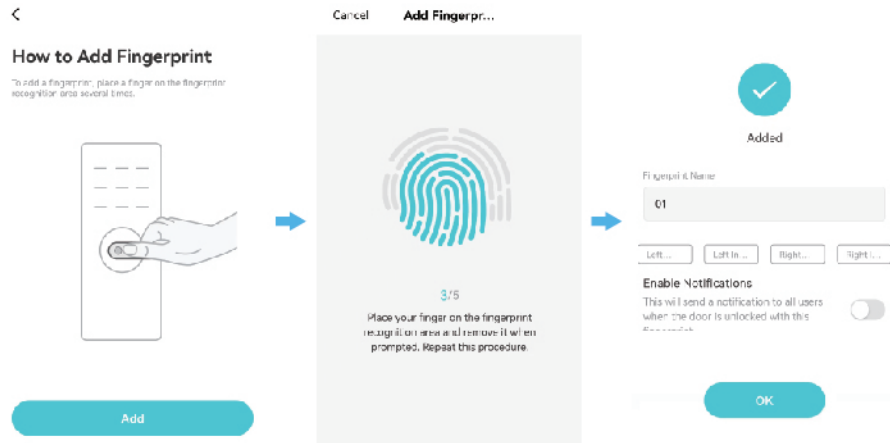

Select Add

Follow the prompts for fingerprint collection

Enter the fingerprint name and click Finish

Setting the Administrator Password / IC Card

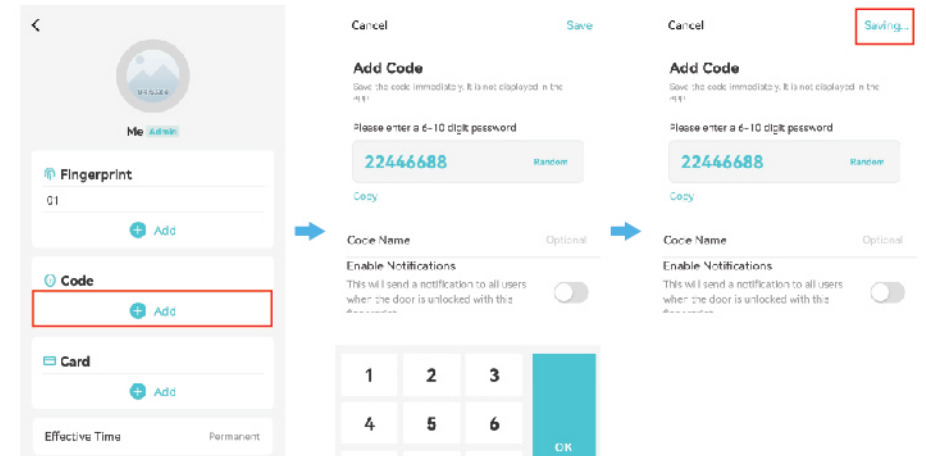

Click Add at the Password location on the Administrator screen

Enter the password

Click save, door lock voice prompt added successfully

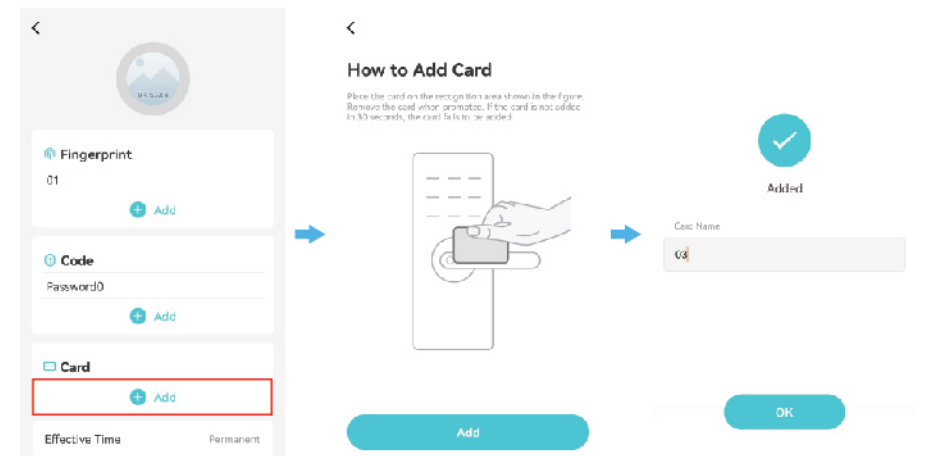

Click Add in the Administrator Screen card location

Click start to add the IC card close to the door lock swipe area

Enter the key card name and click Done

Set a Temporary Code

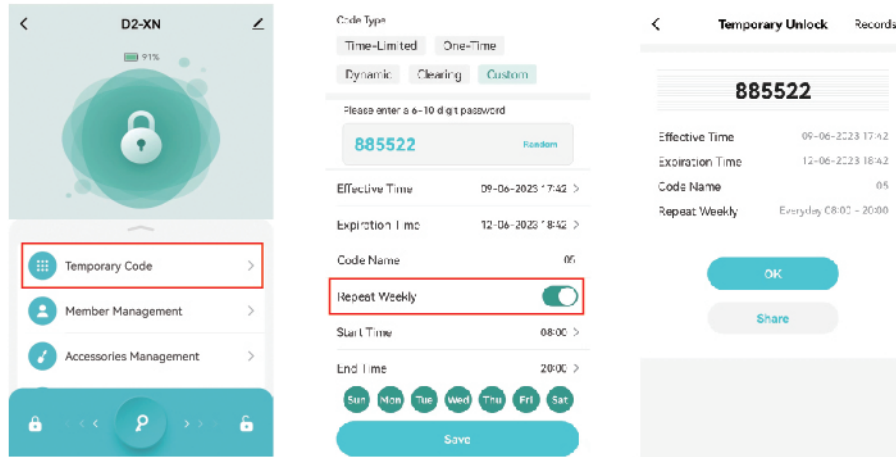

Select a temporary code in the door lock interface

Select custom, enter the password to set the opening time click save

Click Finish or Share

Open Door Record Query

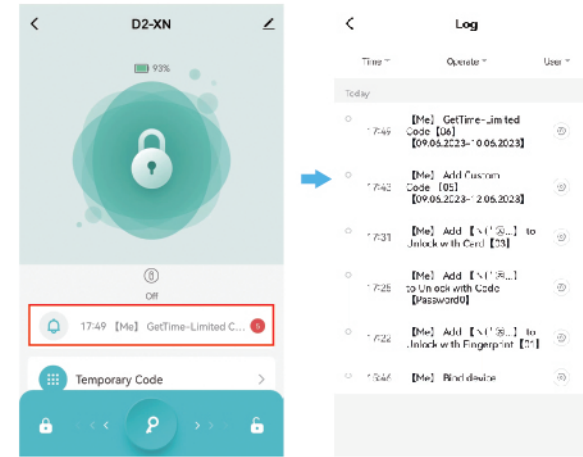

On the main page click on the area

Check the door opening.

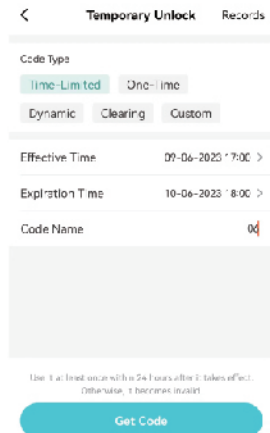

Time-Limited password

Can set the validity period, minimum 1 hour, maximum 1 year. Use it at least once within 24 hours of entry into force, otherwise it will automatically fail.

One-Time password

It is valid for 6 hours and can only be used once before it expires.

Dynamic password

It is valid for 5 minutes and can be used several times before it expires.

Clearing password

Clear all time codes. Valid for 24 hours, after entering the lock, it will clear all the used time limit codes.

APP side unbinding

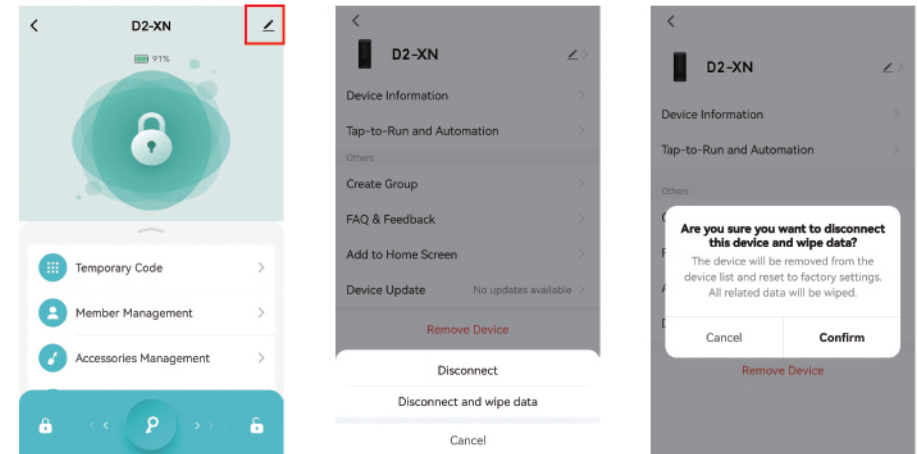

Click on the area

Select Unbind and Clear Data

Click OK to unbind

Menu structure diagram

After waking up the keyboard, enter the "1" + "Enter" key to enter the settings menu. The system displays "Enter administrator information". Enter the management menu. If the administrator information is not registered, you can use any fingerprint or initialization password 123456 + "Enter" to enter the management menu.

Enter the management menu		
Administrator Settings Enter 1	1. Add administrator	
	2. Delete administrator	
	3. Network configuration	
User Settings Enter 2	1. Add users	
	2. Delete user	1 Delete a single user 2 Delete all users
System Settings Enter 3	1. Volume settings	1 Low 2 medium 3 High 0 Mute
	2. Unlock mode setting	1 Single unlocking 2 Combination unlocking
	3. Language selection	1 English 2 Portuguese 3 Spanish 4 Chinese
	4. Door opening direction setting	1 Left door open 2 Right door open
	5. Automatic locking	1 on 2 off ① 5 seconds ② 10 seconds ③ 15 seconds ④ 30 seconds ⑤ 60 seconds
Restore factory Settings Enter 4	Press "Enter" to cancel	
	Press "Enter" to confirm	

1. Add administrator action

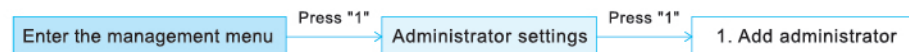

1. After entering the configuration operation, enter the fingerprint password or card that needs to be entered, and the system will automatically assign a key number;
2. The first set of keys is the administrator password, and the system default sequence number is "001"
3. The valid digits of a digital password are 6-8 bits;
4. Fingerprint input 5 times continuously, password input 2 times continuously, and card input 1 time;

2. Delete administrator action



1. Enter the number and press the "Enter" key to confirm, for example: "002" + "Enter"
2. To ensure the normal operation of the system, the administrator for this verification cannot delete it;
3. When the administrator deletes other numbers and enters them again, the system will automatically replace their numbers.

3. Add regular user actions

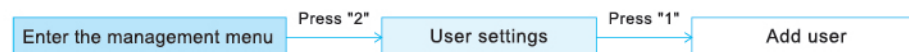

1. After entering the configuration operation, enter the fingerprint, password, or card that needs to be entered, and the system will automatically assign a key number;
2. The valid digits of a digital password are 6-8 bits;
3. Fingerprint input 5 times consecutively, password input 2 times consecutively, and card input 1 time

4. Delete single/all user actions

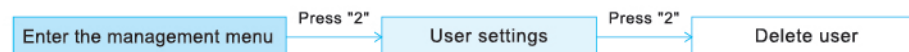

1. "Delete a single user" refers to deleting the corresponding user key. After entering the number, press the "Enter" key to confirm, for example: "010" + "Enter"
2. "Delete all users" refers to deleting all user keys without affecting the administrator key;
3. The range of user numbers is: 002~511;
4. After the user deletes it, the system will automatically replace its number when entering it again.

5. Volume Setting

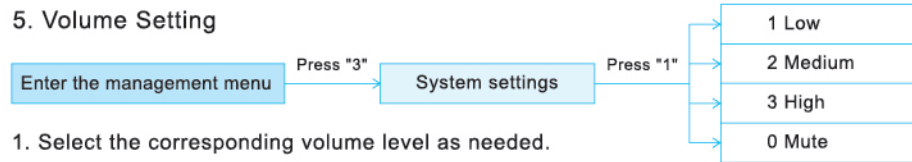

1. Select the corresponding volume level as needed.

6. Unlock mode setting

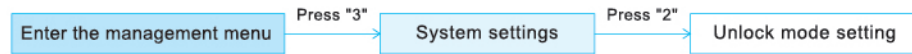

1. "Single unlock" refers to any type of fingerprint password or card that has been entered and can be unlocked;
2. "Combination unlocking" refers to the need for two different sets of keys to be verified in order to unlock;

7. Language selection settings

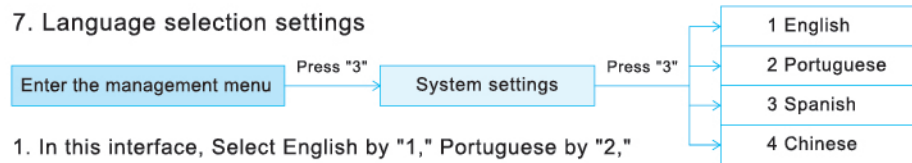

1. In this interface, Select English by "1," Portuguese by "2," Spanish by "3," and Chinese by "4";
2. After the system is initialized, Chinese is selected by default.

8. Unlock direction setting

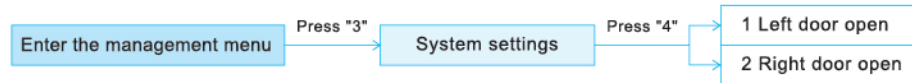

1. On this interface, press "1" to select the left door, and press "2" to select the right door;
2. After system initialization, the unlocking direction will not be affected.

9. Door magnetic switch settings

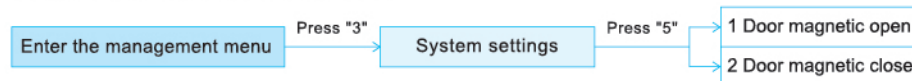

1. Press "1" on this interface to select to turn on the door magnetic switch.
The door magnetic sensor will automatically lock when the door is closed;
2. Press "2" on this interface to select to turn off the door magnetic switch function.

10. Restore factory settings

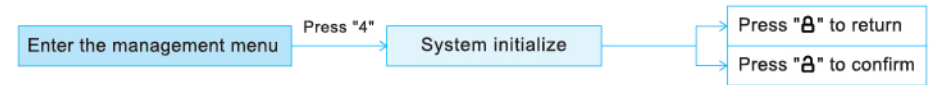

After restoring the factory settings, all data will be cleared, but the language selection and automatic lock function will not be reset and will still operate according to the previous settings.

Restore Factory Settings

When the power is on, press and hold the setting button on the back panel for 6 to 8 seconds, and you will hear a prompt sound indicating that the initialization is successful and the factory settings are restored successfully.

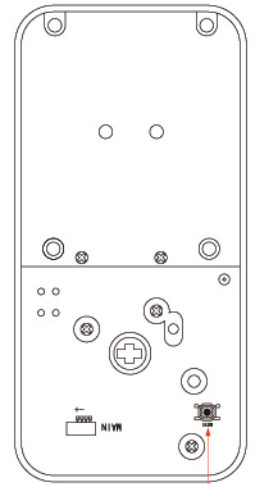

Restore factory setting button

11. One key switch lock

1. Press the "one key switch lock" button on the rear panel to unlock or close the lock;
2. It is possible to unlock or close the lock through a mechanical manual knob.