

## SMART LOCK INSTRUCTIONS

1. Product parameters

USER	Administrator: 10 Ordinaryusers: 502 (Fingerprint, Password, Card, Face sharing) Administrator ID:001-010 Ordinaryuser ID:011-512
Quiescent Current	≤65uA
Dynamic Current	<400mA
Working Voltage	6.5V When unlocking below 4.8V, a low voltage reminder will be broadcast. Please pay attention to replacing the battery;
External Power Supply	5V USB
Operation Temperature	-25℃~70℃
Working Humidity	45~90%RH
Number Of Password Digits	6~12bits
Virtual Password	Virtual password+total length of 26 characters
System Lock	The system automatically locks after 5 failed unlocking attempts Unlock after 3 minutes of automatic locking
Fakeadmission Rate	≤0.00004%
Authenticity	≤0.015%
Normal Open Mode	After successfully unlocking, press and hold the "1" key to enter the normally open mode

Tips: Please store your mechanical key outdoors for backup!

2. Inspection of Basic Fittings

Open the package and take out the products and accessories, check whether the items are complete.

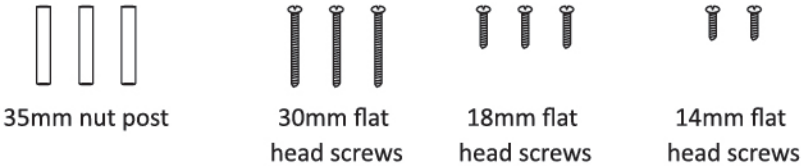
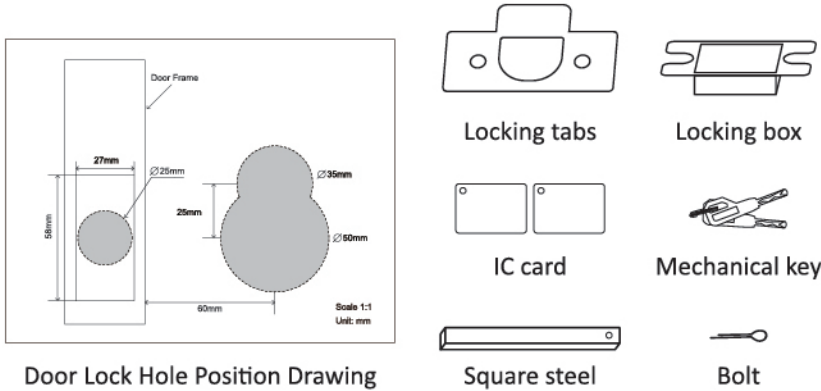
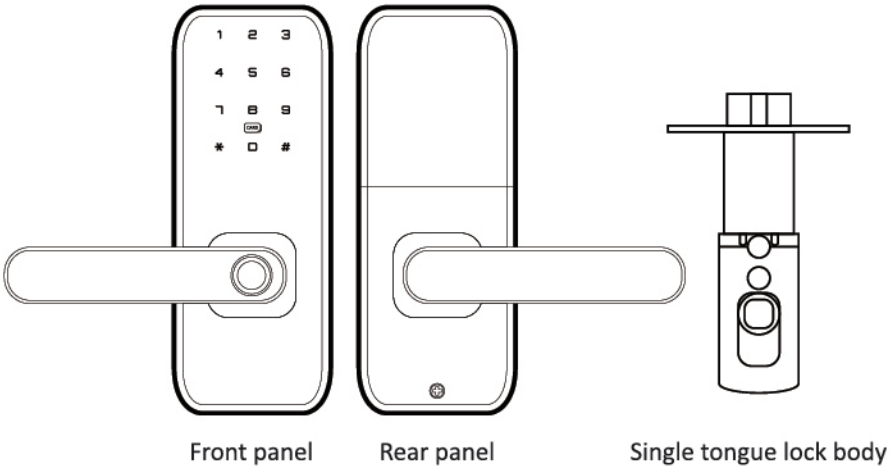

### 3. Door handle reversing left and right

Right door replacement direction:

With double tongue triangle symbol arrow up. When equipped with a single tongue lock body, the triangle symbol is mounted in the R direction.

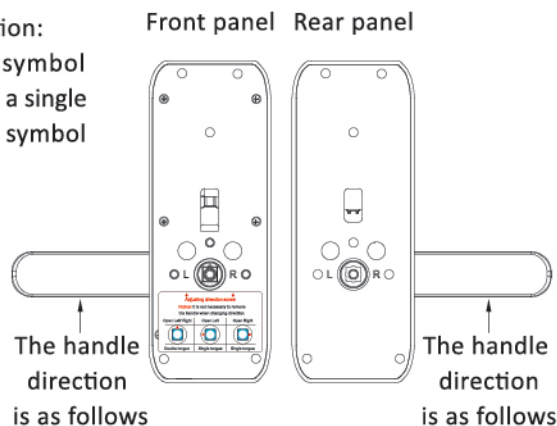

Change direction of left open door:

With double tongue triangle symbol arrow up. When equipped with a single tongue lock body, the triangle symbol is mounted in the L direction.

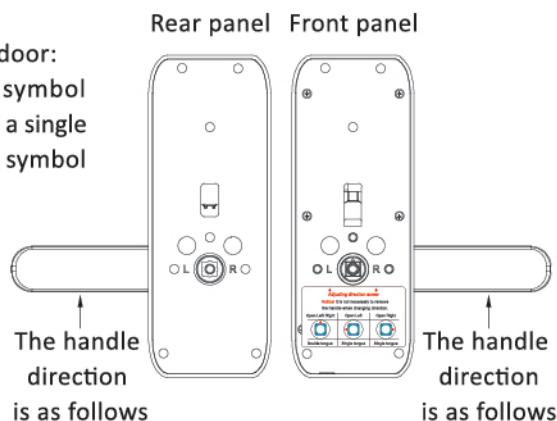

Note: When changing the left and right door handles on the front and back panels, press down the handle about 15°, remove the adjustment screw in the panel with a phillips screwdriver, and install it in another hole.

Screw hole for adjusting direction

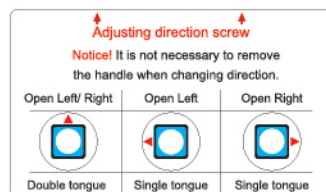

### 4. Installation Steps

#### Installing lock body

Put the lock body into the corresponding door slot and fix the lock body up and down with screws.

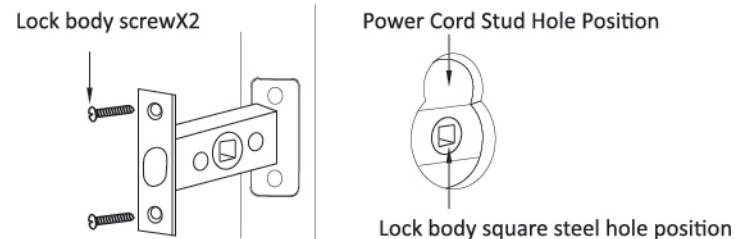

#### Installing the front panel

1. Use the latch to pass through the square steel hole to clamp the latch and fix the square steel on the hole.
2. Screw down the front panel with 3 studs; To use the double tongue lock body just screw the lower 2.
3. Turn the clutch to the corresponding position.
4. Insert the power cord from the front panel through the door hole and insert the stud and square steel into the lock body.
5. Install the silicone pad on the back cover (iron plate), install the corresponding screw to the stud of the front panel and tighten it.

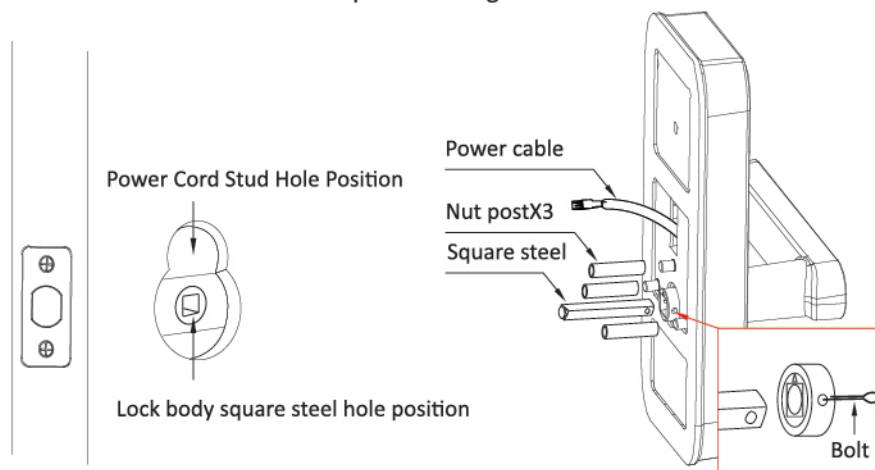

## Installing the rear panel

1. Connect the front and rear panel power cords, and put the surplus power cords into the door frame holes.
2. Remove the battery cover plate, press the handle hole to the end of the square steel, install the two flat head screws on the back panel.
3. Install the four AA batteries and close the battery compartment lid.
4. Test door lock electrification, installation completed.

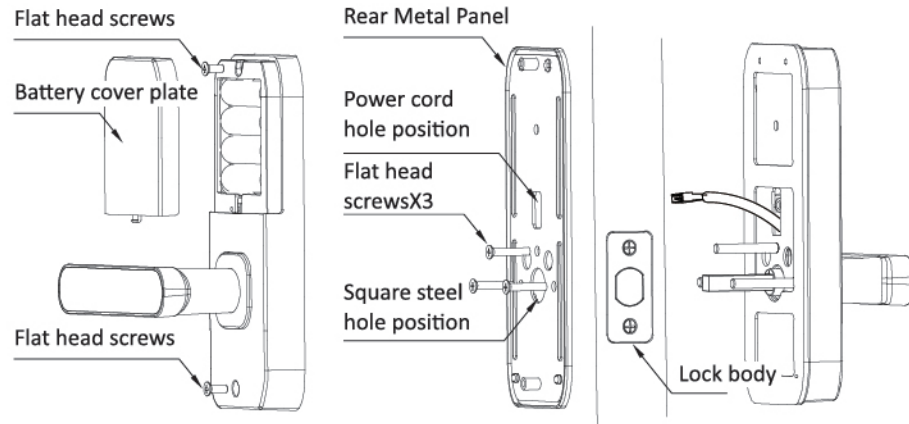

## 5. Product

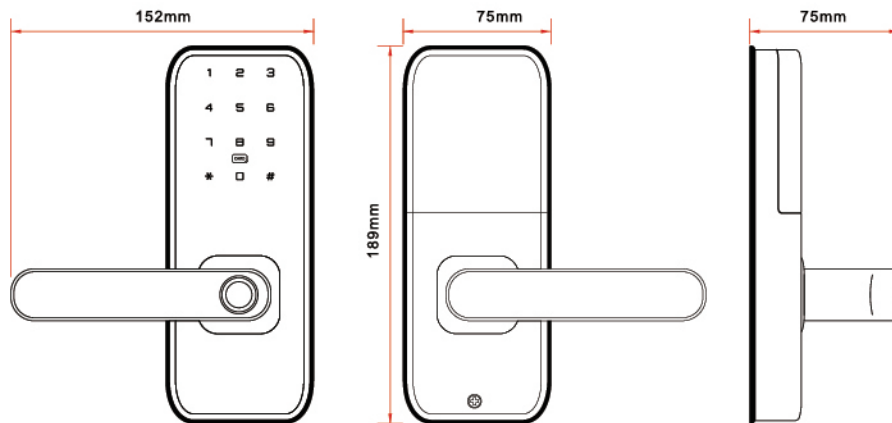

★ Manual measurement, there is error, please refer to the actual product size.

## APP Download and Installation

Search for "tuyazhineng" in the APP Market. This document takes smart life APP as an example to explain in detail the APP & door lock panel function.

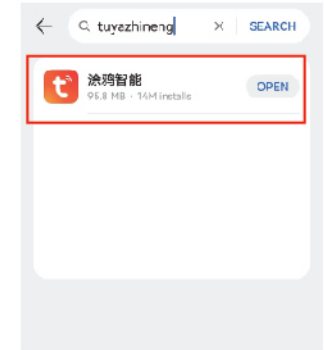

## APP Registration, Login

### APP Registration:

You don't have an APP account yet, choose log in or log in via SMS verification code. Click "Create New Account" to enter the account registration page. Follow the prompts to get the SMS verification code and set the password. If you already have an account, you can click "Log in with an existing account" to log in to the app. Login mode supports password, verification code, social account login.

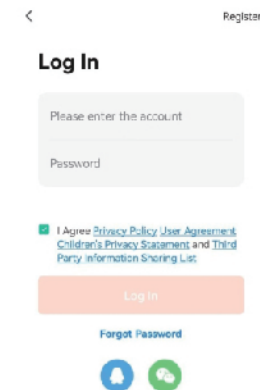
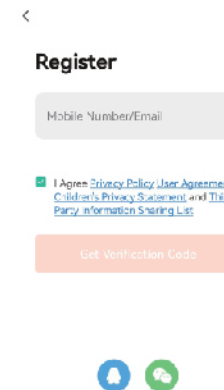

## Add Device

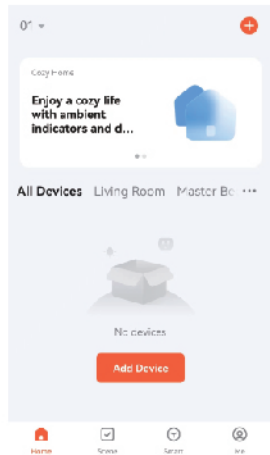

Click Add Device

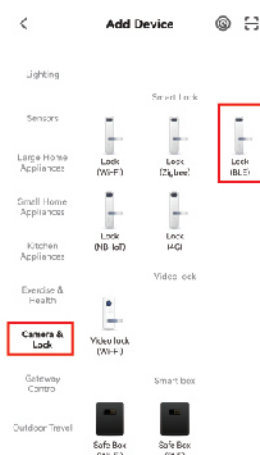

Find the Camera & Lock  
Select Lock (BLE)

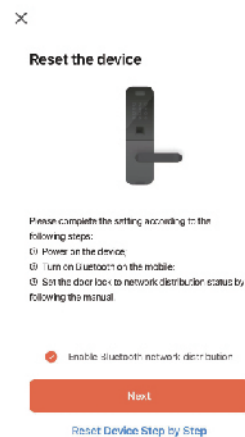

Select Start Bluetooth  
Click Next

## Member Management - Improving Family Members

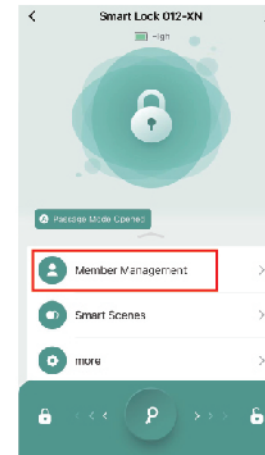

Click Member  
Management

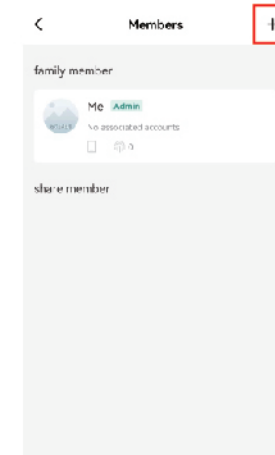

Click "+"  
on the top right

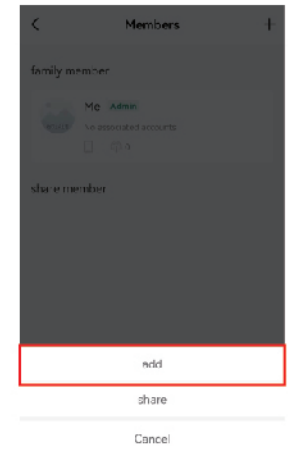

Select add



Touch Fingerprint  
Wake Up System  
Waiting Link Device

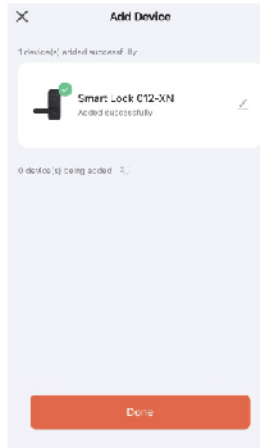

Link Success  
Click to Done

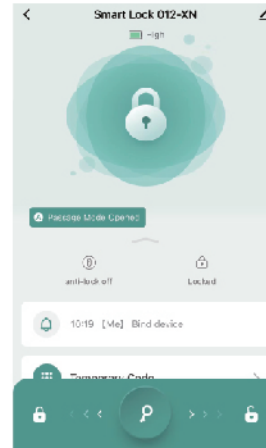

Enter the door lock  
main interface

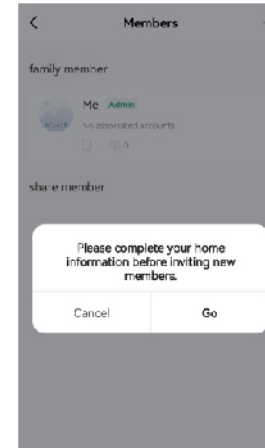

Click Go

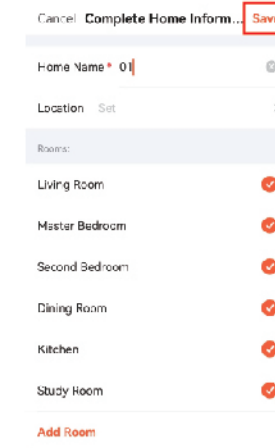

Improving Family  
Information Click Save

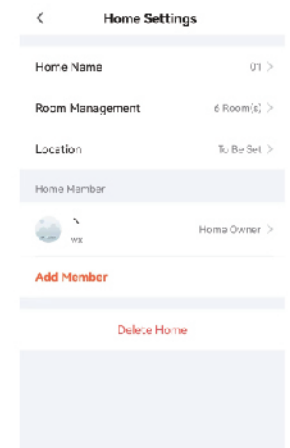

You can rename /  
view / add / remove  
when finished

## Member Management - Set Fingerprint Permissions

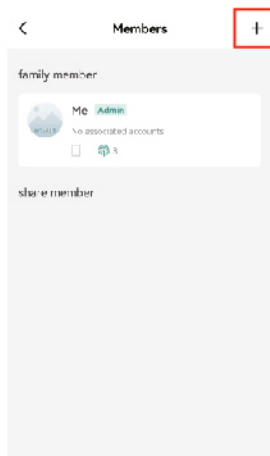

In the Member Admin Panel Click "+"

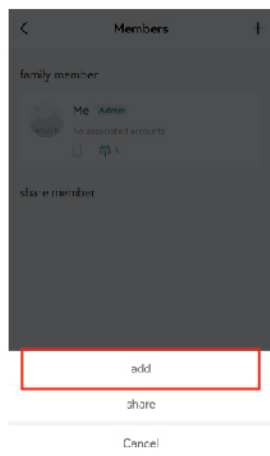

Click add

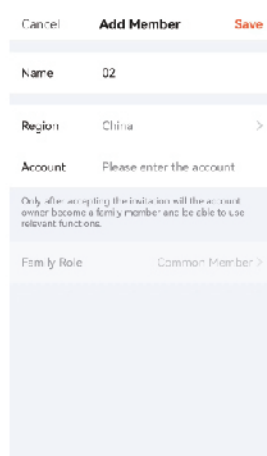

Set Member Name  
Click to save

## Setting the Administrator Fingerprint

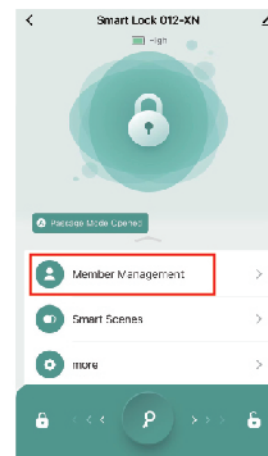

Select Member Management  
in Door Lock Interface

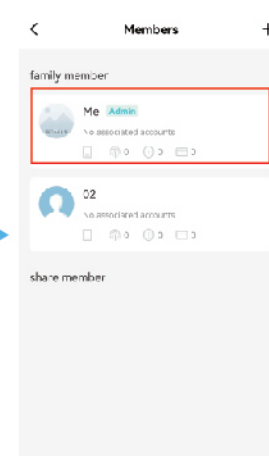

Select Me Admin

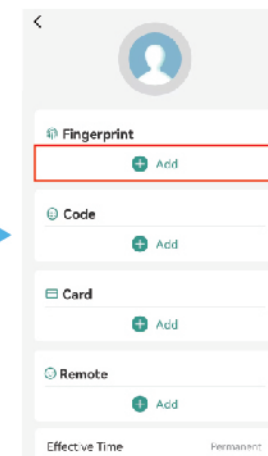

Click Add in the  
Fingerprint location of the  
Administrator Interface

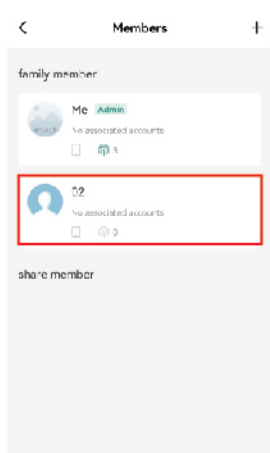

In the Member  
Admin Panel  
Select the member

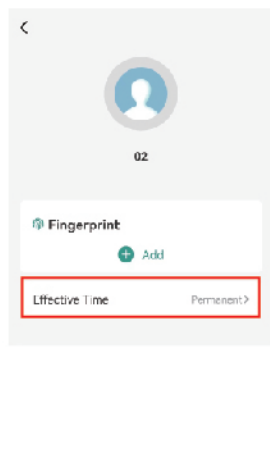

Select Effective Time

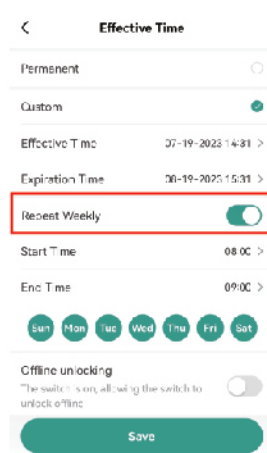

Select Custom, Set  
Fingerprint Permissions  
Click Save



Select Add

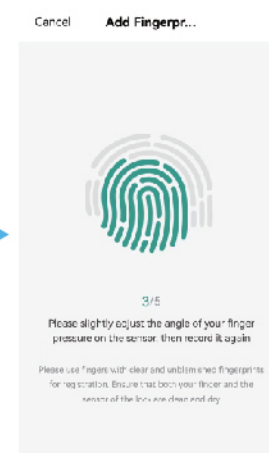

Follow the prompts for  
fingerprint collection

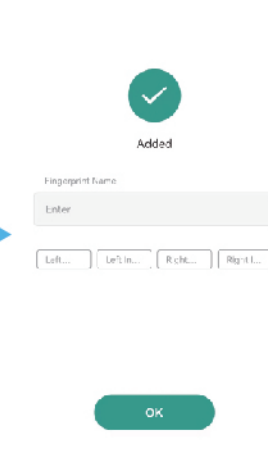

Enter the fingerprint  
name and click Finish



## Setting the Administrator Password / IC Card

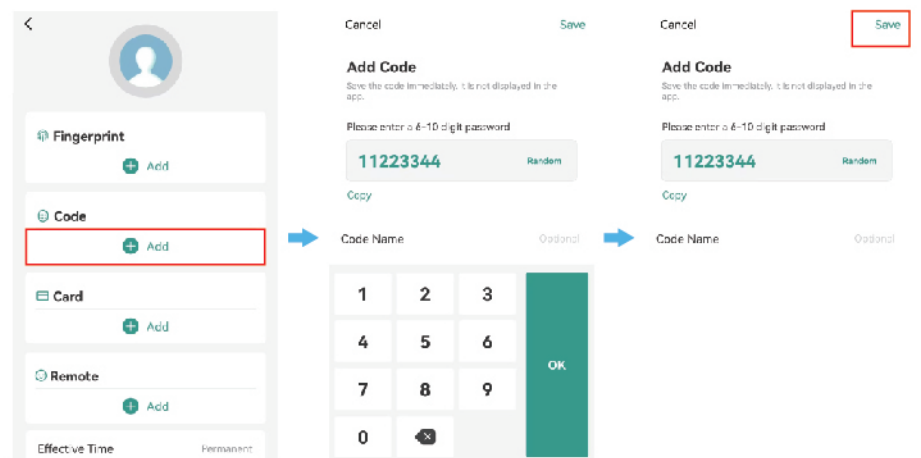

Click Add at the Password location on the Administrator screen

Enter the password

Click save, door lock voice prompt added successfully

## Set a Temporary Code

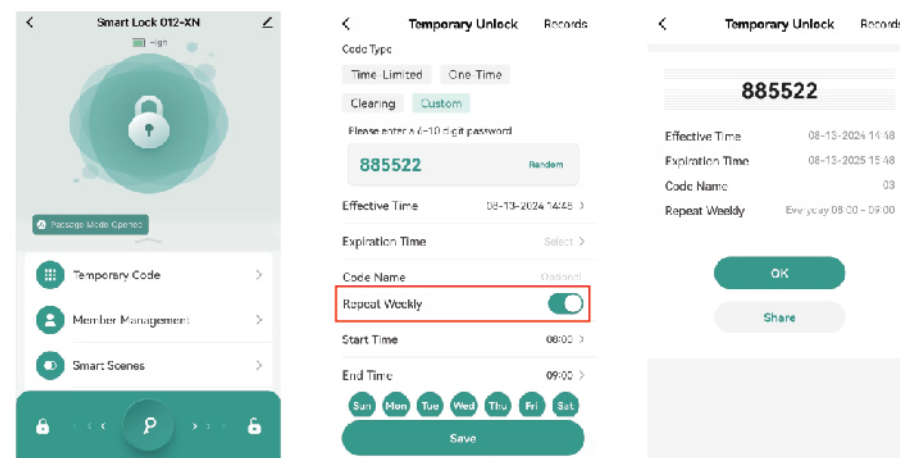

Select a temporary code in the door lock interface

Select custom, enter the password to set the opening time click save

Click Finish or Share

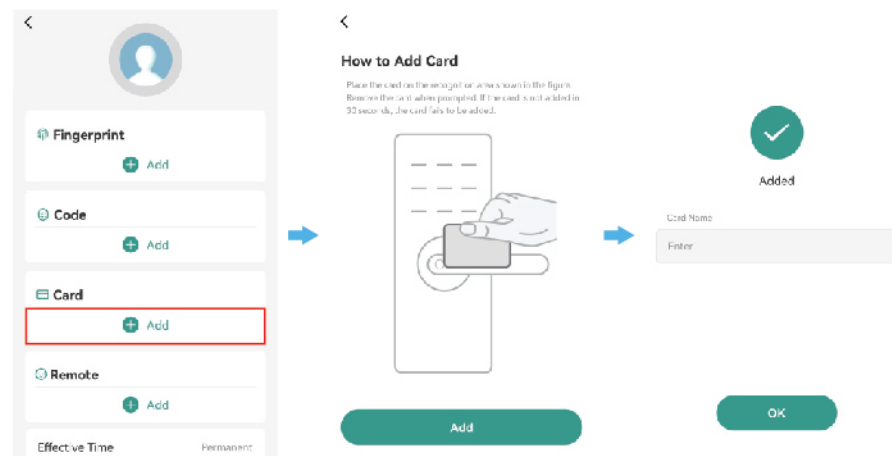

Click Add in the Administrator Screen card location

Click start to add the IC card close to the door lock swipe area

Enter the key card name and click Done

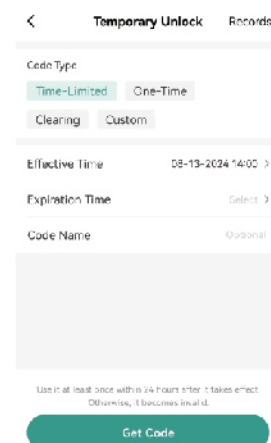

### Time-Limited password

Can set the validity period, minimum 1 hour, maximum 1 year. Use it at least once within 24 hours of entry into force, otherwise it will automatically fail.

### One-Time password

It is valid for 6 hours and can only be used once before it expires.

### Dynamic password

It is valid for 5 minutes and can be used several times before it expires.

### Clearing password

Clear all time codes. Valid for 24 hours, after entering the lock, it will clear all the used time limit codes.

## Open Door Record Query

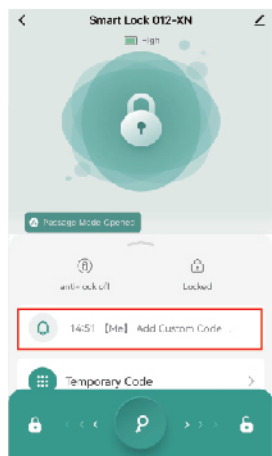

On the main page  
click on the area



Check the door opening.

## APP side unbinding

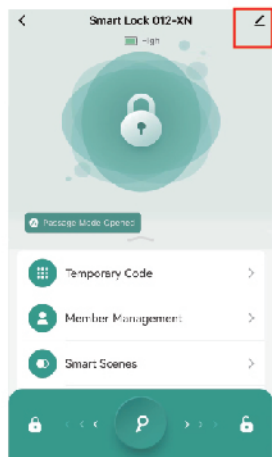

Click on the area

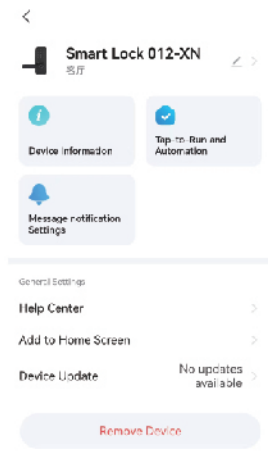

Select Unbind and Clear Data

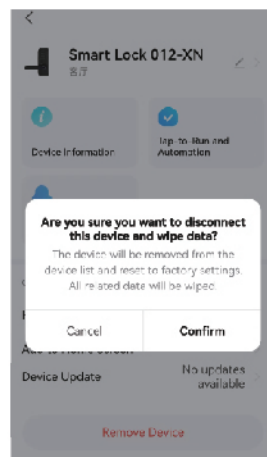

Click OK to unbind

## 6. Introduction to Function Menu

Enter "\*"#" in the initial interface to enter the administrator menu.

Note: Verify the administrator key to enter the administrator menu. If you have not registered as an administrator, enter "123456#" to enter the menu.

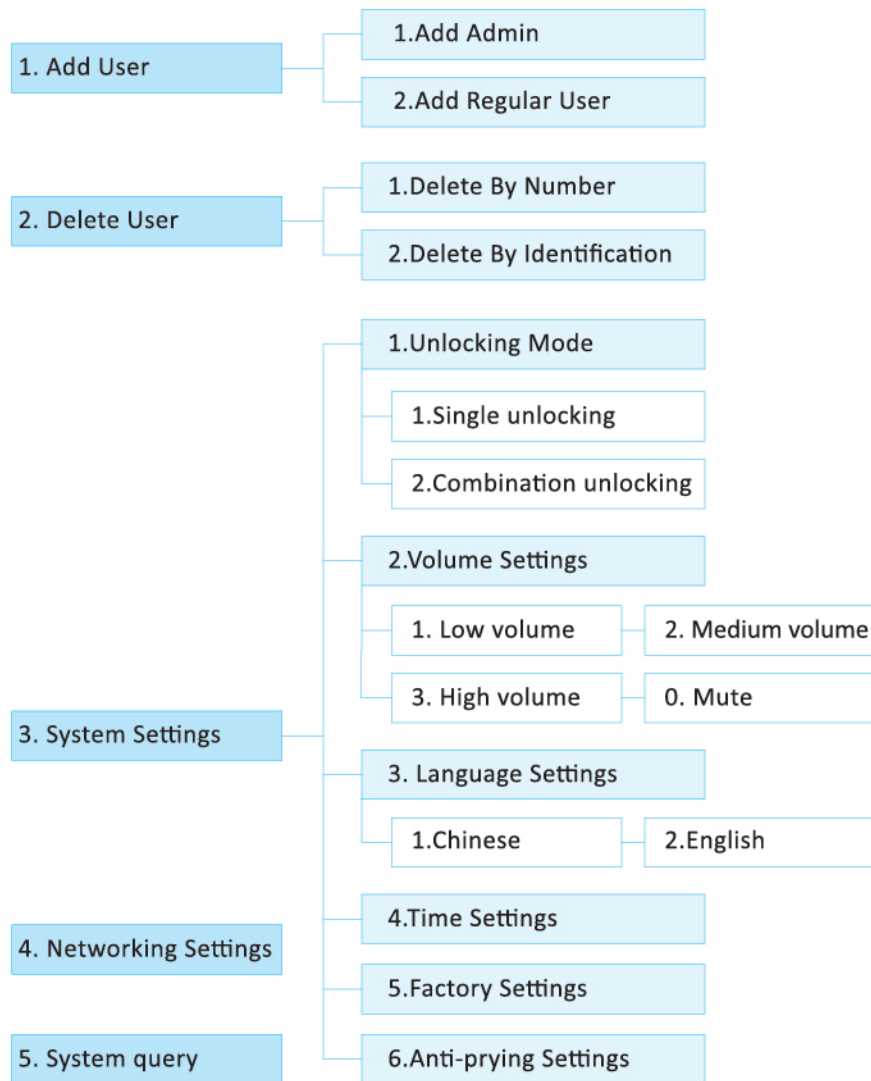



## 1. User Management

### 1. Add administrator



- Administrator ID : 001-010.
- The system will automatically register in sequence;

### 2. Add regular users

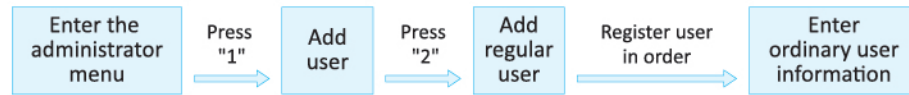

- Administrator ID : 011-511.
- The system will automatically register in sequence;

### 3. Delete user

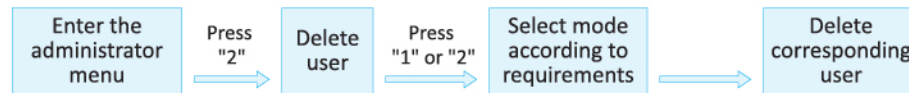

There are two ways to delete users: number deletion and identification deletion.  
Number deletion: Enter the corresponding number of the user to be deleted;  
Identify deletion: Enter the starting information of the user to be deleted.  
Both administrator and ordinary user information can be deleted. For the normal operation of the system, the administrator verified in this verification cannot be deleted; After deleting a user, the vacancy will be automatically filled at the next registration;

## 2. System Settings

### 1. Unlock mode setting



There are two unlocking modes available: Single unlocking and combined unlocking;  
Single unlocking: Simply verify a set of unlocking methods (password, fingerprint, or any set of cards) to complete the unlocking operation;  
Combination unlocking: Two sets of passwords (password, fingerprint, or any two sets in the card) need to be verified in order to complete the unlocking operation.

### 2. Volume setting



This system has four modes :High volume, medium volume, low volume, and mute.  
Please choose the corresponding volume level according to your personal needs.

- Low volume : After entering this mode, press "1";
- Medium volume : After entering this mode, press "2";
- High volume : After entering this mode, press "3";
- Mute : After entering this mode, press "0".

After selecting mute, except for entering the administrator menu, the system will not perform voice broadcasting in other situations.

### 3. Language setting



This system has two modes: Chinese and English.  
Please choose the language mode according to your personal needs.

### 4. Time setting



This setting is used to set the system time, providing accurate time for unlocking records and temporary keys.

## 5. Restore factory settings (Two methods to choose from)

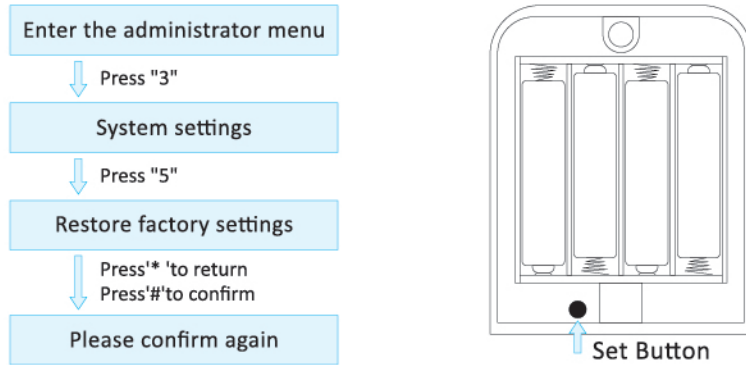

**Method 1:** After restoring the factory settings, the registered administrators and ordinary users in the system will be cleared; To verify the administrator or unlock again, please enter the initial password "123456" to pass the verification;

**Method 2:** Press and hold the "Set Button" button on the back panel for 3 seconds, and the panel "\*" # will light up. Press the "#" key to confirm factory reset.

## 6. Anti prying setting



1. This mode can be set to enable or disable the anti prying mode. Please choose according to personal needs.

## 3. System query

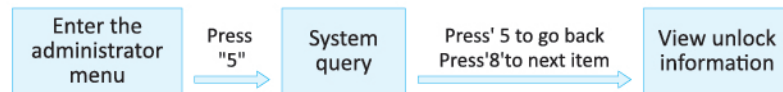

1. Before viewing the unlocking information, please set the system time based on the actual time;

2. After entering this setting, the system will automatically broadcast the unlocking record and press the "\*" key to exit.

## Operating Manual

- Thank you for purchasing this product.
- Please read this manual carefully before use.
- Please keep this manual for future reference.
- This instruction manual is subject to change without notice.
- The company does not assume the accident and harm caused by user's wrong operation

## Note :

- o When leaving the factory, all users are blank and can be verified by the administrator or unlocked with "123456".
- o After waking up the interface, enter "\*" # to enter the administrator menu.
- o First administrator, please use password as administrator information.
- o The " \* " key indicates return, and the "#" key indicates confirmation.
- o Kind reminder: Please store your mechanical key outdoors for backup!