

Intelligent lock usage instructions

tuya®-Wifi

1. Product parameters

Number of users:	Number of fingerprint storage: 100 PIN + IC Card Number of Storage: 100
Quiescent Current:	≤65uA
Dynamic Current:	<250mA
Working Voltage:	6.5V When unlocking below 4.8V, a low voltage reminder will be broadcast. Please pay attention to replacing the battery;
External Power Supply:	5V USB
Opening method:	APP, fingerprint, password, IC card, key
Normal Open Mode:	After unlocking using administrator information successfully unlocking, press and hold the "5#" key to enter the normally open mode
Operation Temperature:	-25℃~60℃
Working Humidity:	20%-80%RH
Number Of Password Digits:	6~10bits
Virtual Password:	Virtual password+total length of 22 characters
System Lock:	The system automatically locks after 5 failed unlocking attempts Unlock after 3 minutes of automatic locking
Fakeadmission Rate:	≤0.00004%
Authenticity:	≤0.015%

Tips: Please store your mechanical key outdoors for backup!

Installation Notes

Install the lock body

Left and right reversal of lock body

When installing, the lock body, the oblique tongue should face upward, and the oblique surface of the oblique tongue should face the direction of the front panel. If it does not match, the direction of the oblique tongue should be adjusted, Methods as below:

- Turn the lock body upside down, with the oblique tongue facing down, and let the oblique tongue stop block lean down. As shown in ②
- Press the oblique tongue by hand into the lock body to the end and rotate it 180°.
- Release the oblique tongue, let the oblique tongue pop out along the oblique tongue hole, and reverse the lock body Figure ③

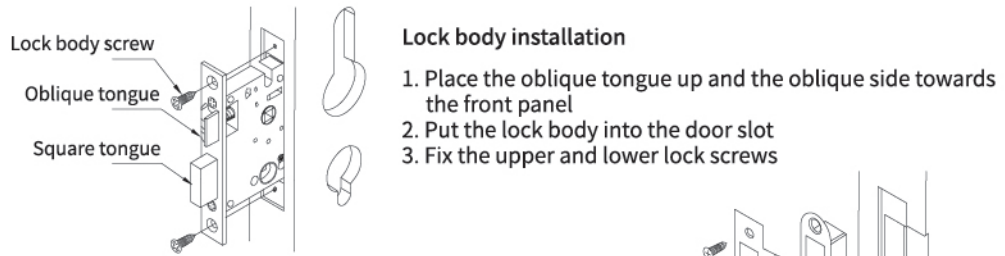
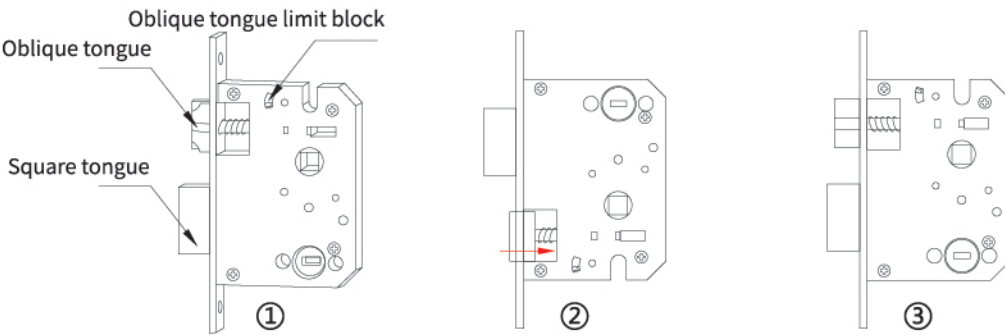

Door buckle plate, door buckle box installation

- Slot the door frame at the position corresponding to the
- Lock tongue. Put it into the card slot according to the order
- As shown in the picture. Fix with two lock body screws

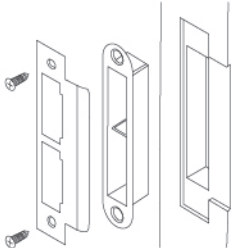

Door handle reversing left and right

Open the right door and change the direction:  
To open the right door, turn the clutch triangle symbol to the "50" position.  
Note: When equipped with a single tongue lock body, turn the triangle symbol to the R direction to install.

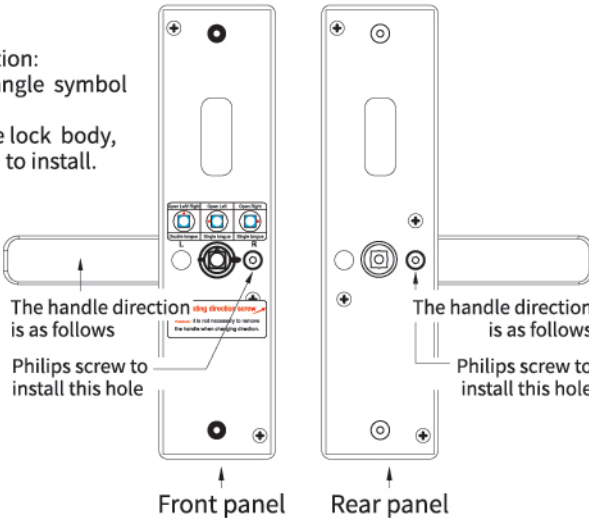
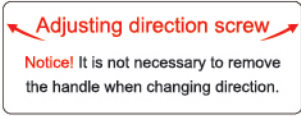

Reversing the direction of the left door:

When opening the door on the left, rotate the clutch triangle symbol to the "50" position.  
Note: When equipped with a single tongue lock body, turn the triangle symbol to the L direction to install.

Note:

When changing the left and right door handles on the front and rear panels, use a Philips screwdriver to remove the Phillips adjusting screw handle in the panel and rotate it upwards 180°, and install it into another hole with a Phillips screw.

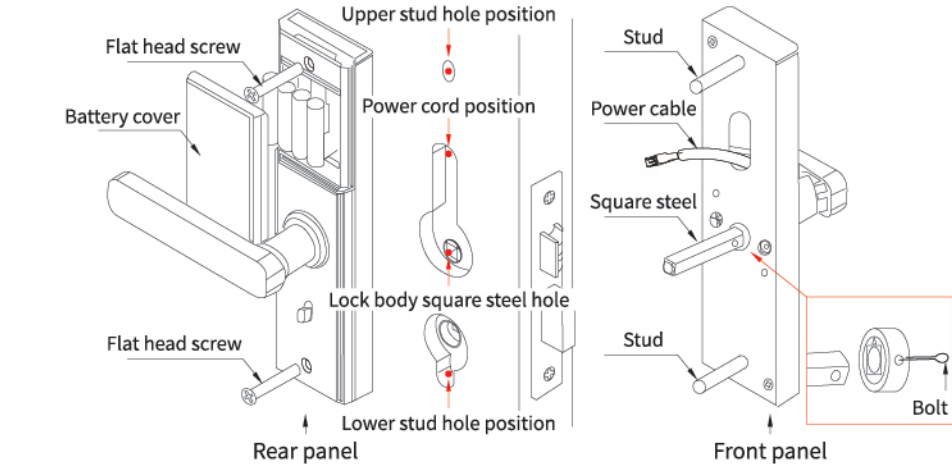
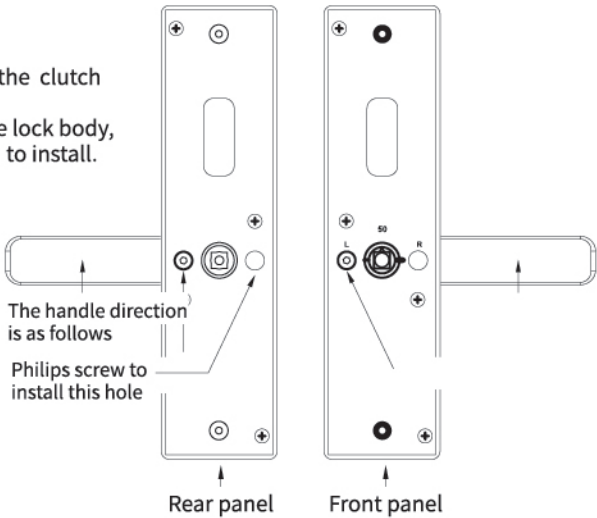

Install the front panel

- First tighten the two studs on the front panel.
- Insert the hole end of the square steel into the square steel hole of the front handle and align it with the two small round holes.
- Pass the pin through the square steel hole, and bend the pin to fix the square steel on the hole.
- Turn the square steel so that the clutch triangle symbol rotates upwards.
- Pass the power cord from the front panel through the hole on the door.
- Pass the upper and lower studs of the front panel through the corresponding holes on the door.
- Pass the square steel through the square steel hole of the lock body.
- Fasten the front panel to the door.

Install the rear panel

- Remove the battery cover from the rear panel.
- Connect the rear panel power cord to the front panel power cord.
- Insert the square steel into the hole of the rear handle.
- Align the upper and lower holes on the rear panel with the positions of the upper and lower studs on the front panel.
- Put two flat head screws into the upper and lower holes of the rear panel, and align them with the front panel studs to tighten.
- Install four batteries and close the battery compartment cover.
- Test the power supply of the door lock, and the installation is complete.

User Management

1. Add administrator function

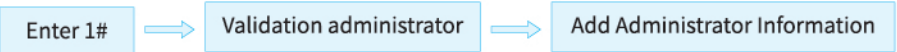

Note:  
When an administrator is not registered, "123456" can be used for administrator validation;  
Administrator information registration can be done using passwords, fingerprints, and cards.

2. Add regular user functions

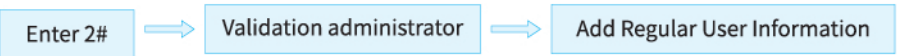

Note:  
Please add an administrator in advance before adding regular users;  
Regular user information registration can be done using passwords, fingerprints, and cards.

3. Delete user function

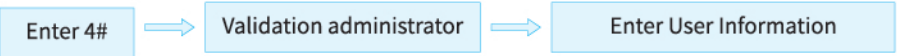

Note:  
To ensure the normal operation of the system, the verified administrator user cannot be deleted;  
After entering the deletion mode, enter the user information that needs to be deleted, press the # key to confirm, and if successful, the message "Operation successful" will be displayed.

4. Language switching function



Note:  
This function must be operated in initialization mode. Language codes:  
11:English 12:Portuguese 13:Spanish 14:Russian 15:Arabic 16:Indonesian 17:Vietnamese 18:Chinese 19:Thai.

Example: Switch to English. In initialization mode, enter "889911#" to switch to English.

5. Normal Open Mode



Note:  
This function is only available to administrators. After unlocking using administrator information, the keyboard 5 and # keys light up. After reentering 5 #, the normally open mode can be opened.

6. Volume Setting

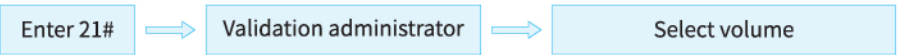

Note:  
When an administrator is not registered, "123456" can be used for administrator verification;  
When entering the function menu, the 0, 1, 2, and 3 keys will be illuminated, and the volume can be changed by selecting the corresponding button;  
3: High volume, 2: Medium volume, 1: Low volume, 0: Mute.



## 7. Restore factory settings

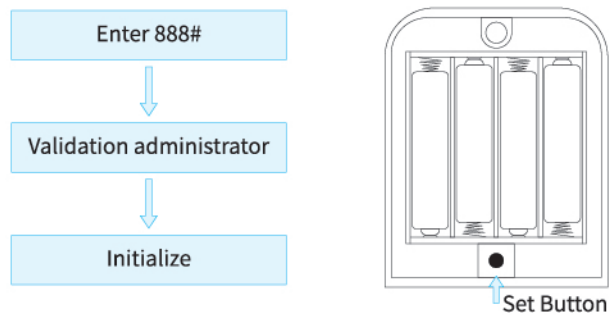

Note:  
Enter "888 #" to verify that the administrator is successful, and initialization will be carried out immediately;  
You can also enter forced initialization mode by long pressing the initialization button on the back panel for 6 seconds;  
After initialization, all user information stored within the system will be eliminated, and the system will enter an initialization state.

## 8. networking function (need to be equipped with Wifi module to achieve)

★ Note: Ordinary stand-alone version does not have graffiti wifi function, wifi connection does not support 5G waylay.

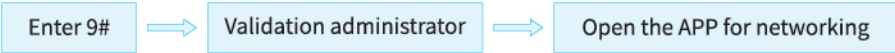

### A. Networking settings

Please search and download the "Tuya Smart" APP in the app store, or scan the QR code to download it, and remind registered users according to the software;

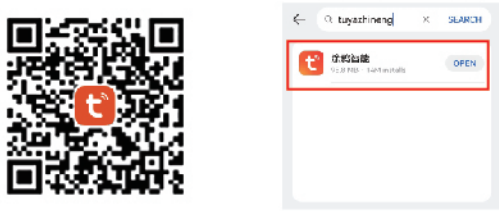

## APP Registration, Login

Do not have an APP account, choose log in or log in via SMS verification code. Click Create New Account to enter the account registration page. According to the prompts to obtain SMS verification code, set password. If you already have an account, click "Log in with an existing account" to log in to the app. Login support password, verification code, social account login. After the lock body enters the network configuration, open the "Tuya Smart" APP to pair the lock body, and enter the WiFi name and password used;

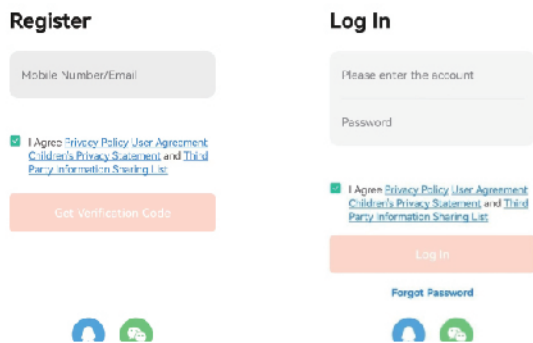

## Add Equipment

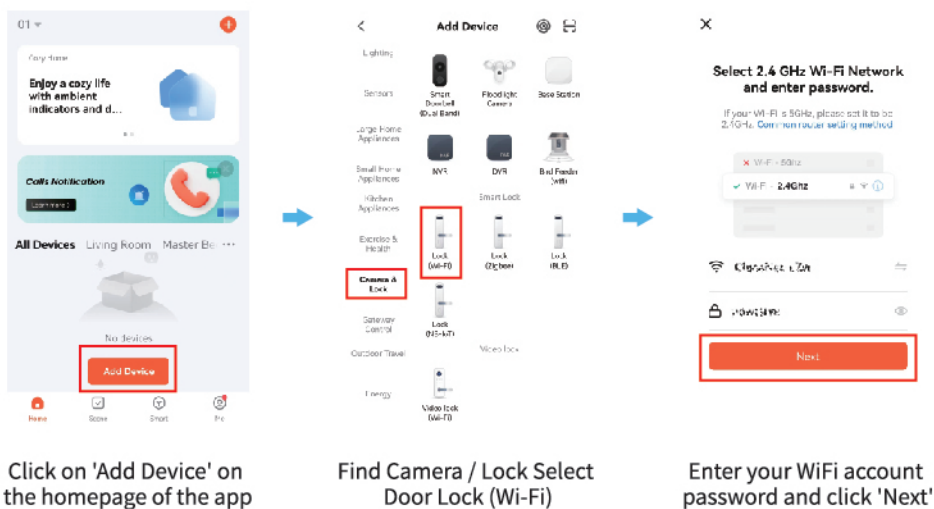

### B. Software function

1. Remote unlocking : Wake up the door lock, click the door bellkey, you can apply for remote unlocking, through the software confirmation, you can complete the unlocking operation;

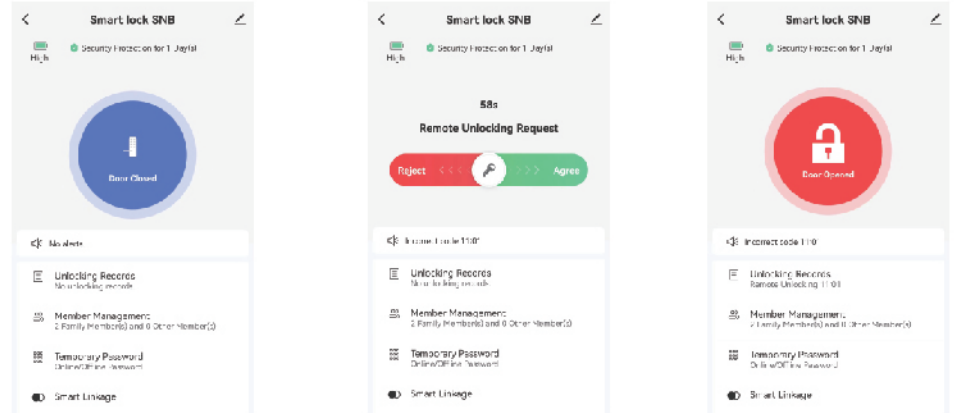

2. Temporary password function: one-time password and unlimited number of passwords can be added;

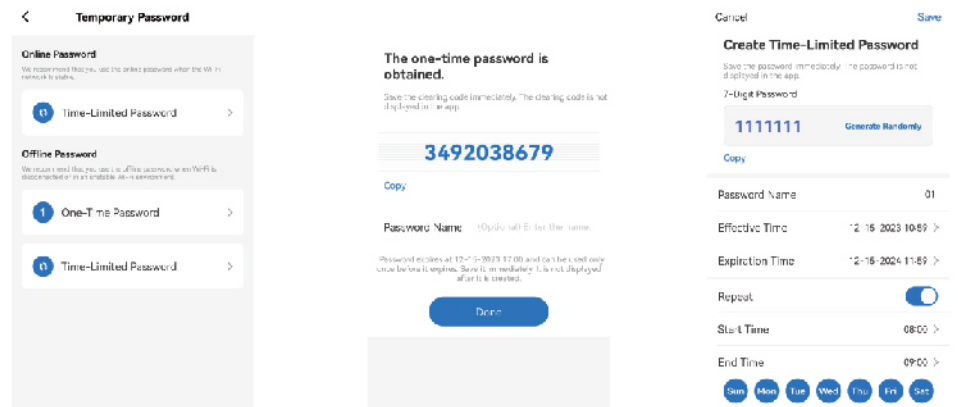

Note: The one-time password is valid for 6 hours and can only be used once within the validity period; Time-Limited password Validity time and expiration time can be set. The number of unlocking times is not limited during the validity period;

3. Door opening record function: After the connection is successful, the software will record the work record of the door lock, including the user and operation record of the unlock;  
4. Alarm record notification: The system automatically records the incorrect unlocking operation and pushes it to the software;

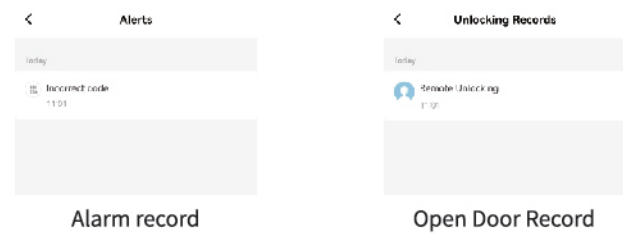

5. User management function: Users can be added on the software. Click the corresponding user on the user management page to add fingerprints, passwords and cards.

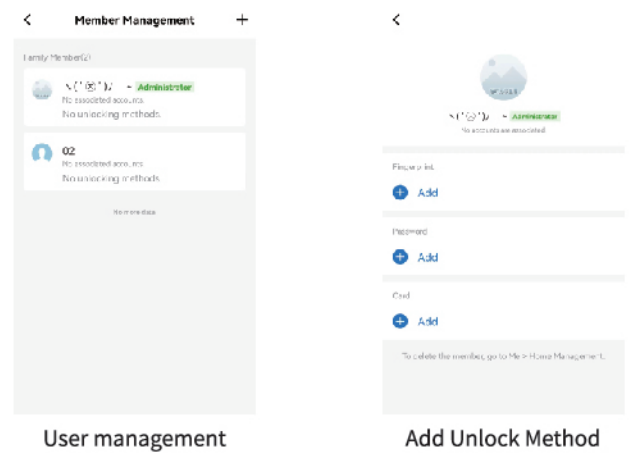

### 6. Removal of equipment

